



Far West Project GREAT
Socorro I. S. D. - Community Services
313 S. Rio Vista Rd.
El Paso, Texas 79927

Phone: 915.937.1725
Fax: 915.860.3728
Email: farwestg@farwestgreat.org

www.farwestgreat.org

TRANSITIONS:

*Step Up
to the Future*

**EPALL VII
Conference**



UTEP
El Paso
October
21-22,
2010

Presented by:



Far West GREAT Center
www.epall.org

MAP OF MEETING ROOMS

University of Texas at El Paso

Union Building East

3rd Floor

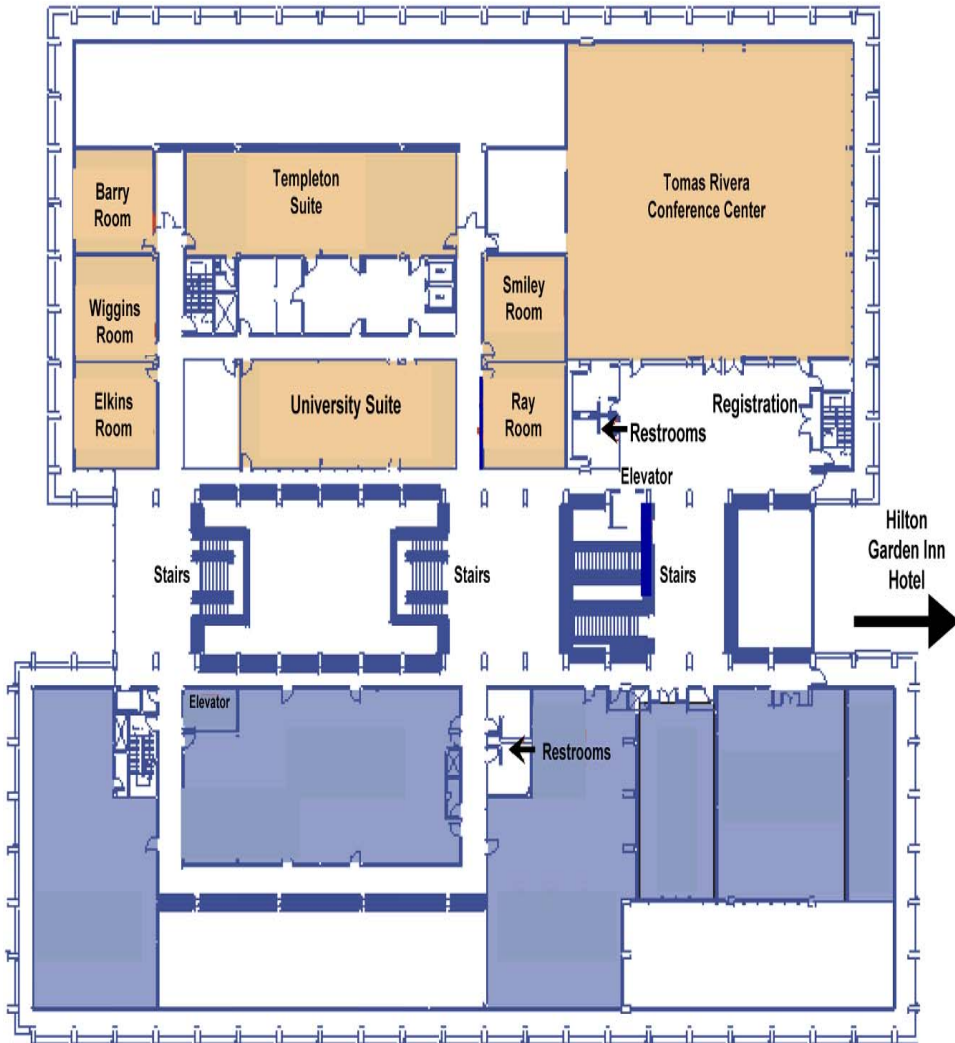
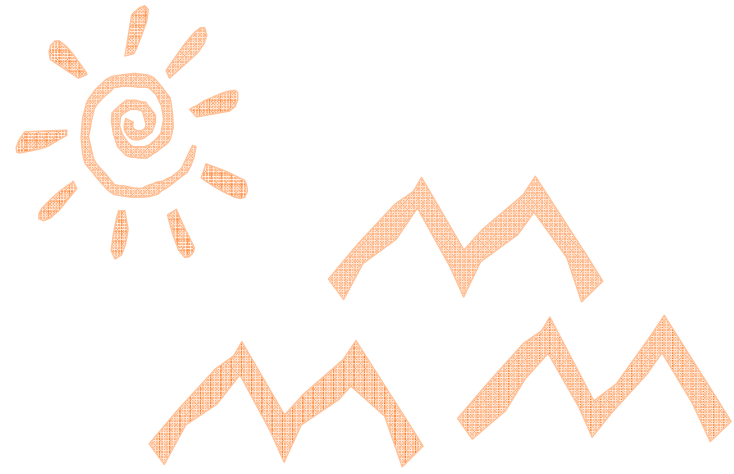

Diagram Not to Scale



**Welcome to
El Paso, Texas!**

EPALL VII

October 21-22, 2010



Far West Project GREAT Advisory Council

Ana Romero	— San Jacinto Adult Learning Center
Ana Macias	— UT at El Paso - <i>West Project GREAT</i>
Blanca Andrade	— San Jacinto Adult Learning Center
Ernesto Mata	— AVANCE - El Paso Chapter
Elizabeth Moya	— Ysleta Community Learning Center
Fred Anaya	— Ysleta Community Learning Center
Ignacio Solis	— Clint I. S. D. - Federal Programs
John Stevenson	— Texas LEARNS
Julia Correa	— Canutillo I. S. D. - <i>Even Start Program</i>
Martha Serna	— Socorro Community Learning Center
MariCarmen Casavantes	— El Paso Community College - Literacy Programs
Oswaldo Grijalva	— Socorro Community Learning Center - <i>Even Start Program</i>
Rena Miller	— Opportunity Center for the Homeless
Sara Martinez	— El Paso Community College - Literacy Programs
Susan Tollefson	— El Paso Community College - LEAP Program
Teofilo Ugalde	— Upper Rio Grande Workforce Solutions

Far West Project GREAT Staff Members

MARIA J. CESNIK
Program Coordinator
915.937.1703
mcesni@sisd.net

MARY JO OCHOA
Grant Specialist
915.937.1706
mochoa16@sisd.net

LETY JONES
Administrative Specialist
915.937.1725
ljones01@sisd.net

www.farwestgreat.org

Special thanks to:

AVANCE—El Paso Chapter
Opportunity Center for the Homeless
Canutillo Independent School District
Clint Independent School District
El Paso Affordable Housing
El Paso Community College - Literacy Programs
El Paso Convention & Performing Art Centers
El Paso Independent School District

El Paso SADDLEBLANKET Co.
San Elizario Independent School District
Socorro Independent School District
South Central Project GREAT Center
Texas Adult Education Credential Project Staff
Texas Center for Adult Literacy and Learning
Texas LEARNS
Ysleta Independent School District

Steck-Vaughn®



Tracy Springer | HMH
Sr. Sales Representative | Steck-Vaughn Adult Education
T. 866.365.7550 | C: 817.690.6980
E: tracy.springer@hnhpub.com

www.steckvaughn.com/adulted

Ask me about our 2 new assessments!

GAIN
<http://everythingtogain.com/adult-basic-education>

National Workforce Readiness Credential

<http://workreadiness.com>

Products
The Leader in Adult Education and GED® Preparation

FUTURE



English for Results
PREPARE • PRACTICE • PERSIST



Kendra G. Whittaker, ELL Specialist
 Serving the states of:
 AZ-NM-NV-UT-El Paso, TX
 Mobile: **480-274-2614**
 Fax: **480-634-8426**
 Office: **480-634-7180**
 Email: kendra.whittaker@pearson.com



www.pearsonlongmanusa.com/specialists
www.pearsonlongmanusa.com/future

TABLE OF CONTENTS

<i>Far West Project GREAT Advisory Council and Staff</i>	4
<i>Table of Contents</i>	5
<i>Welcome from the Far West Project GREAT Center</i>	6
<i>Welcome from the Mayor of El Paso</i>	7
<i>Keynote Speaker</i>	8
<i>Featured Presenters</i>	9
<i>Thursday Sessions at a Glance</i>	10
<i>Friday Sessions at a Glance</i>	12
<i>Conference Presentation Descriptions</i>	14
<i>Directory of Exhibitors</i>	23
<i>Directory of Presenters</i>	24
<i>Marketing Ads</i>	26
<i>Map of Meeting Rooms</i>	30

INSERTS

Overall Conference Evaluation - Blue

Conference Attendance Sheets (Thursday and Friday) - Green and Yellow

7th Annual El Paso Adult Learning and Literacy Conference

University of Texas at El Paso

October 21 - 22, 2010

Welcome to EPALL VII!

We are very pleased to welcome you to the Seventh El Paso Literacy and Learning Conference in El Paso. EPALL is sponsored by the Far West GREAT Center and we enjoy and appreciate the support provided by area adult education and family literacy programs. The world of adult education is in constant, evolving change and we strive to help you keep abreast of them. Given the many state leadership activities currently in place, we chose the theme of *Transitions: Step up to the Future* for this conference in order to underscore our full support for all programs and teachers working to transition and guide their students to the next level. As usual, this year's conference includes first-class speakers, presenters, and vendors; it is our hope that the 50 sessions offered will help to inspire you and renew your energies to continue leading adult students in their efforts to achieve their educational goals and, ultimately, self-realization.

A really special feature of this year's conference is the participation of adult education and family literacy students from local programs. Welcome, students, and thank you for being here representing your colleagues and your programs. We are very proud of you and hope you benefit from this exciting experience and enjoy yourselves too. Also, we give kudos to your program administrators for sending you to EPALL VII.

We extend a very warm welcome to all our out-of-town and out-of-state guests and hope you will find some time to enjoy the rich diversity our city offers. Please let us know if you need any suggestions for eating out and places to see.

The Far West GREAT Center is committed to making this conference experience as worthwhile and enjoyable as possible. Don't hesitate to contact any of the Conference staff if you have any questions or concerns. Also, we would like to request that you fill out the conference evaluation form before you leave so we can make this an even better conference next year.

Finally, we would like to express our appreciation to all of our presenters, exhibitors, adult education and family literacy programs, GREAT Centers, and state leadership for their continued support for the EPALL Conference and the promotion of adult literacy in our region.

With our warmest regards,

Maria J. Cesnik
Mary Jo Ochoa
Lety Jones

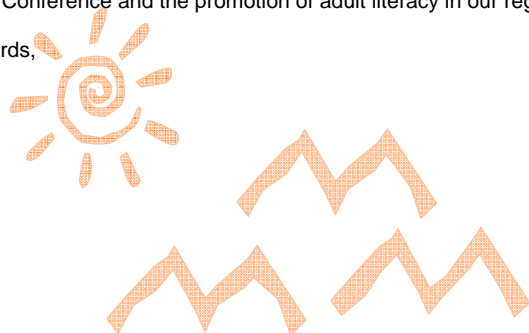

Introducing the NEW 2nd edition of

English in Action!



Students learn better and are more motivated when they can put English into action.

The new 2nd edition of *English in Action* is:

- Fun!
- Engaging!
- Action-packed!

Get your free samples and Test-Drive Kit
at the Heinle booth and
meet your new Heinle representative Patrick Whitsel.



For valuable information on pricing, previous editions, changes to current editions and alternative formats, please visit elt.heinle.com (search by ISBN, author, title or keyword).

CAMBRIDGE

Ventures motivates low-advanced learners by developing skills for success in workplace or college.

New Transitions Level!

Vincent Di Blasi
 Toll Free Number: 800-580-3711
 Office: 210-826-6397
 Fax: 210-826-6398
 Email: vdiblasi@cambridge.org

Ventures



El Paso, Texas

The International City

JOHN F. COOK
MAYOR

October 2010

WELCOME! BIENVENIDOS!

As Mayor of El Paso, it is truly an honor and pleasure to welcome all the participants and distinguished speakers of The Seventh El Paso Adult Literacy and Learning Conference (EPALL). I am very pleased that you have chosen El Paso for this important event. I commend the administrators, educators and students of adult education programs for addressing literacy challenges in the El Paso region.

El Paso is a city rich in southwestern beauty and border history with tradition and cultural diversity throughout. As the "Paso Del Norte" (Pass to the North), El Paso has been the cross roads for numerous expeditions and incursions (in both directions), each of which provided its influence as the region developed from initial Indian and Spanish settlers to the population of today. El Paso is the largest bi-national border community in the world.

My best wishes for a most successful conference and visit.

Sincerely,

John F. Cook
Mayor of El Paso

KEYNOTE SPEAKER***Dr. Lennox McLendon***

Lennox McLendon has over thirty years experience in adult education and literacy. He began as a part-time teacher and over the years has taught ABE, GED, Adult High School, and ESL. For six years he was a local adult education program manager.

After his years at the local level, he spent a little over ten years with the Virginia Department of Education as a regional consultant for 30 local adult education and programs. The next twelve years he was state director of adult education in Virginia.

His professional contributions during that time included Chair of the National Coalition for Literacy, leadership roles with the national council of state directors, and advisory roles with partners such as the American Bar Association's Law and Literacy Initiative.

Currently, he is the Executive Director of the National Adult Education Consortium. In that role he has two functions: First, to respond to the adult education information needs of the Congress and White House staff members. Secondly, to facilitate professional development activities for the state directors of adult education and their staff members.

Lennox received his doctoral degree in adult education from Virginia Tech. He holds a Master of Adult and Community College Education from North Carolina State University and a Bachelor of Arts degree in Political Science from the University of North Carolina at Chapel Hill.

CONFERENCE DIRECTORY**PRESENTERS**

J. Arturo Muro R.
Arthur Moore & More
muroart@yahoo.com

Dr. Thomas G. Sticht
Educational Consultant
tsticht@znet.com

Manuel Navarro
Southwest Texas Junior College
m91alejandro@aol.com

Kimberly Vinton
ESC Region XX
Kimberly.vinton@esc20.net

Susan Pittman-Shetler
E-Learning Connections
Skptvs@aol.com

Bill Walker
Wonderlic, Inc.
Bill.walker@wonderlic.com

Laurel Pollard
Educational Consultant
lpollard@dakkotacom.net

Stacey Weaver
Victoria College Adult Education
Stacey.weaver@victoriacollege.edu

Dr. Elizabeth Quintero
California State University Channel Islands
Elizabeth.quintero@csuci.edu

Patti White
St. Philip's College, Phoenix Program
pwhite@saisd.net

Irene Ramos
Independent Consultant
ireneiramos@yahoo.com

Sarah Worthington
Educational Consultant
sarahworthington@hotmail.com

Melissa Sadler-Nitu
Seguin ISD, Adult Education
Mnitu@seguin.k12.tx.us

Sandi Schneider
South Central Project GREAT
sschneider@cebridge.net

Bev Schumacher
Learning Props, L.L.C.
bev@learningprops.com

Richard Sedillo
South Central Project GREAT
rggsedillo@aol.com

Harriet V. Smith
TCALL
hsmith@tamu.edu

Carol Speigl
Project Learn to Read of San Antonio
cspeigl@gmail.com

John Stevenson
Texas LEARNS
jstevenson@hcde-texas.org

CONFERENCE DIRECTORY

PRESENTERS

Dr. Jean Andrews
Lamar University
Jean.andrews@lamar.edu

Debby Hewitt
ESC Region XX
Debby.hewitt@esc20.net

Bronwyn Bowen
Abilene Adult Education
bbowen60@gmail.com

Karla Horelica
ESC Region VI
jesusmymorningstar@yahoo.com

Anthony Chan
Texas LEARNS
achan@hcde-texas.org

Tiffany Johnson
Victoria College Adult Education
Tiffany.johnson@victoriacollege.edu

Vincent DiBlasi
Cambridge University Press
vdiblasi@cambridge.org

Denise Johnson
Denise_sumlin@yahoo.com

Leah Diaz
El Paso Affordable Housing
ldiaz@epcuah.com

Brittany Kellerman
El Paso Affordable Housing
bkellerman@epcuah.com

Ellen Doyal
South Central Project GREAT
Ellen_doyal@earthlink.net

Mary Lorenz
The Education Institute
mlorenz@txstate.edu

Amelia Gilley
Adult Education Consultant
ameliaGilley@gmail.com

Sarah Lynn
Pearson Longman ELT
LynnSarah@comcast.net

Bonnie Goonen
E-Learning Connections
bv73008@aol.com

Dr. Ana Macias
University of Texas at El Paso
ahmacias@utep.edu

Denise Guckert
Central Project GREAT
dg21@txstate.edu

Rita McSorley
South Central Project GREAT
EaglesMom@aol.com

Judy Harris
Frankford Candy Co. and University of
Phoenix
harristad@verizon.net

Dr. Steven Meeker
Montgomery ISD
stevenmeeker57@gmail.com

Kieran Healy
El Paso Affordable Housing
khealy@epcuah.com

Stacey Milberger
Victoria Adult Literacy Council
staceymilberger@gmail.com

Travis Hewgley
McGraw-Hill ESL
Travis_hewgley@mcgraw-hill.com

Emily Moore
TCALL
emoore@tamu.edu

Continued on next page...

FEATURED PRESENTERS

Laurel Pollard



Laurel Pollard has been a teacher and teacher educator for more than 30 years and is enjoying it more all the time. She taught for many years at the University of Arizona and now leads workshops all over the world. Her books include *Creative Questions*, *Yours For the Asking*, *Zero Prep: Ready-to-Go Activities for the Language Classroom*, *Zero Prep for Beginners*, *Now You're Talking*, *WOW! Stories From Real Life*, and (in press) *Finding Family*. Laurel shares strategies that are best practices and require little or no preparation time by the teacher. Her aims: to make teachers' lives easier and more effective, and to provide students with tools for success once they move beyond our classrooms.

Dr. Thomas Sticht



Dr. Thomas Sticht is an international consultant in adult education. He has taught at Harvard University and published over 170 books and articles on adult literacy. In 1997 the *Reading Research Quarterly* reported that his research and that of Paulo Freire were the two most influential lines of adult literacy research in the last 30 years. He is a member of the Reading Hall of Fame, and in 2003 he was awarded UNESCO'S Mahatma Gandhi medal for his 25 years of voluntary work on UNESCO'S International Literacy Prize Jury.

CONFERENCE SESSIONS AT A GLANCE

Thursday, October 21, 2010

THURSDAY, OCTOBER 21, 2010			
7:30 – 8:00 a.m.	Registration, Breakfast, Vendor Exhibits		Lobby Area
VENDORS/PUBLISHERS			
Adult Education Specialists	Cambridge University Press	CTB McGraw-Hill	Heinle Cengage Learning
McGraw-Hill ESL	Pearson Longman ELT	Steck-Vaughn Adult Education Publishers	TCALL
TIME	SESSIONS	PRESENTER	LOCATION
8:00 – 8:15 a.m.	Welcome	Maria J. Cesnik	Tomas Rivera
	Special Welcome	Joanie Rethlake	Tomas Rivera
8:15 – 9:30 a.m.	General Session	Dr. Lennox McLendon	Tomas Rivera
9:30 – 9:45 a.m.	Break	Lobby Area	
9:50 – 10:50 a.m. <i>(1 hour)</i>	1. The Pythagorean Theorem for All Students -- Ss	Richard Sedillo	Ray Room
9:50 – 11:50 a.m. <i>(2 hours)</i>	2. Peer Mentors: Former Adult Education Students Planting Post-Secondary Seeds	Angelica Garay, Joana Valles, Eva Hinojosa	Barry Room
	3. How Do You Manage Your Classroom? A Poster Session!	Carol Speigl	Elkins Room
	4. The ESL Classroom: Prepping for the Work Place	Ellen Doyal	Smiley Room
	5. Math Tools for Kindergarten, GED and Beyond	Anthony Chan	Templeton Suite
	6. Stress-Reduction Techniques for Teachers and Students -- Ss	Laurel Pollard	University Suite
	7. The Oracy Workshop	Dr. Thomas G. Sticht	Wiggins Room
11:00 – 12:00 p.m. <i>(1 hour)</i>	8. Free Distance Learning Curricula for ESL -- Ss	Denise Guckert	Ray Room
12:00 – 1:00 p.m.	EPALL 2010 Luncheon and Success Stories	Tomas Rivera Conference Ctr.	
1:10 – 3:10 p.m. <i>(2 hours)</i>	9. Diving Into Distance Learning -- Ss	Tiffany Johnson, Stacey Weaver	Barry Room
	10. What About Factoring and Quadratic Equations? -- Ss	Richard Sedillo	Elkins Room
	11. Building Family and Early Literacy Skills by Creating Books -- Ss	Bev Schumacher	Ray Room
	12. Feed the Student, Feed the Racing Mind -- Ss	Amelia Gilley	Smiley Room
	13. Are Your Students Ready to Write? Transitioning Beyond the Five-Paragraph Essay	Bonnie Goonen, Susan Pittman-Shetler	Templeton Suite
	14. Zero Preparation Activities for Speaking and Listening -- Ss	Laurel Pollard	University Suite
3:10 – 3:25 p.m.	15. Developing Oral Communication Using Hands-on Activities	Sandi Schneider	Wiggins Room
	Break	Lobby Area	

-- Ss = Sessions appropriate for Students

CONFERENCE DIRECTORY

EXHIBITORS

ADULT EDUCATION SPECIALISTS
Ann Beeson
ann@adulthoodspecialists.com

CAMBRIDGE UNIVERSITY PRESS
Vincent DiBlasi and Heather Ferreyra
vdblasi@cambridge.org
Hgray@cambridge.org

CTB McGRAW-HILL
Elma Pineda-Raney, Ed. D.
Elma_pineda-raney@ctb.com

HEINLE CENGAGE LEARNING
Patrick Whitsel and Eric Brendenberg
Patrick.whitsel@cengage.com
Eric.brendenberg@cengage.com

McGRAW-HILL CONTEMPORARY
Marty Pitts
marty_pitts@mcgraw-hill.com

McGRAW-HILL ESL
Travis Hewgley
travis_hewgley@mcgraw-hill.com

PEARSON LONGMAN ELT
Kendra Whittaker
kendra.whittaker@pearson.com

STECK-VAUGHN/HARCOURT ACHIEVE
Tracy Springer
Tracy.springer@hmhpub.com

TCALL (Texas Center for the Advancement of Literacy and Learning)
Susan Morris and Harriet V. Smith
sjmorris@tamu.edu
emoore@tamu.edu

SPECIAL THANKS TO THE FOLLOWING SPONSORS



For sponsoring the reception



For sponsoring the Conference name badges



For sponsoring the Conference bags



For sponsoring the Billy Townes Jazz Trio for the reception

CONFERENCE PRESENTATIONS

CONCURRENT SESSIONS FRIDAY, OCTOBER 22, 2010 3:10-4:10 P.M.

47. RATIO, PROPORTIONS AND PERCENTS TEMPLETON SUITE

Manuel Navarro, Southwest Texas Junior College

Proportion is a mathematical concept that can be applied to every day situations that involve working with percents. It is an easy and effective way to solve simple problems and at the same time, introduces the student into higher Math thinking skills.

Target Audience: Instructors, ABE/GED

48. HANDS ON LEARNING—MATH UNIVERSITY SUITE

Irene Ramos, Independent Consultant

Teaching math can be fun! Math is all around us and instructors can use these natural patterns to help students improve their math skills as well as their critical thinking and problem solving skills. The use of manipulatives in the classroom can help to make math real for students.

Target Audience: General Audience, Students, ABE/GED, Numeracy, Transitions

49. SHARING SOME STUFF FROM MY BIG BAG OF TRICKS WIGGINS ROOM

Rita McSorley, South Central Project GREAT

For the adult education instructor/tutor who seeks tips on how to engage students and enhance learning, this interactive workshop will focus on the effective use of brain-friendly manipulatives, visual aids, realia and props in the ABE/ASE/GED/ESL classroom to grab attention, illustrate concepts and generally create an enjoyable learning environment.

Target Audience: Instructors, ESL, ABE/GED, Fam. Lit., EL Civics

50. PREPARE FOR THE JOB YOU WANT! RAY ROOM

Judy Harris, Frankford Candy Co. and University of Phoenix

The unemployment rate has reached more than 10% in the US. Those who are unemployed use the internet, networking, referrals, and direct applications as a resource to obtain employment. There is also a group of adults that are employed who are planning or would like to leave their present employer. However, many of these adults do not have current skills for job hunting, interviewing, or resume preparation. Adults may have to relearn resume preparation, applying online, and networking skills.

Target Audience: General Audience, Students, Workforce Literacy, Transitions

CONFERENCE SESSIONS AT A GLANCE

Thursday, October 21, 2010 (Continued)

THURSDAY, OCTOBER 21, 2010			
TIME	SESSIONS	PRESENTER	LOCATION
3:30 – 4:30 p.m. (1 hour)	16. Financial Literacy: A New Approach to GED Education	Brittany Kellerman, Kieran Healy, Leah Diaz	Barry Room
	17. Dictionary Dust Blowers	Sarah Worthington	Elkins Room
	18. All-Star, Second Edition -- Ss	Travis Hewgley	Ray Room
	19. Math Strategies for the GED	Dr. Steven Meeker	Smiley Room
	20. The First Lady's Family Literacy Initiative for Texas – A Great Opportunity for Community-Based Literacy Programs!	Harriet V. Smith, Emily Moore	Templeton Suite
	21. Prepare for the Job you Want! -- Ss	Judy Harris	University Suite
	22. The Hilton Challenge - Changing Lives Through the TISESL Program	Karla Horelica	Wiggins Room
4:30 p.m. – END OF FIRST DAY SESSIONS			

-- Ss = Sessions appropriate for Students

CONFERENCE SESSIONS AT A GLANCE

Friday, October 22, 2010

FRIDAY, OCTOBER 22, 2010			
7:30 – 8:00 a.m.	Registration, Breakfast and Vendor Exhibits		Lobby Area
VENDORS/PUBLISHERS			
Adult Education Specialists	Cambridge University Press	CTB McGraw-Hill	Heinle Cengage Learning McGraw-Hill Contemporary
McGraw-Hill ESL	Pearson Longman ELT	Steck-Vaughn Adult Education Publishers	TCALL
TIME	ACTIVITY	PRESENTER	LOCATION
8:10 – 9:10 a.m. (1 hour)	23. Reading and Language Development of Deaf Adults	Dr. Jean Andrews	Barry Room
	24. Teaching in the Multilevel Classroom	Sarah Lynn	Elkins Room
	25. Don't Choose Materials for your Class, CREATE Them!	Travis Hewgley	Ray Room
	26. Conversation Circles and Other Creations that "Dynamize" Your Class	J. Arturo Muro R.	Smiley Room
	27. The Most Often Missed Questions on the GED Tests of Language Arts, Writing and Mathematics	Bill Walker	Templeton Suite
	28. Geometry is Just Plane Fun!	Bonnie Goonen, Susan Pittman-Shetler	University Suite
	29. Lexiles for Transitions - Using Technology to Guide Instruction	John Stevenson	Wiggins Room
9:10 – 9:25 a.m.	Break	Lobby Area	
9:30 – 11:30 a.m. (2 hours)	30. Low Level Learners: Teaching Tips	Bronwyn Bowen	Barry Room
	31. Young Children and Families: Transitions Through Story and Literacy -- Ss	Dr. Elizabeth Quintero	Elkins Room
	32. Putting the Pages Together: A Total Approach to Reading	Stacey Milberger, Tiffany Johnson	Ray Room
	33. Professional Portfolios for Post-Secondary Transitions	Melissa Sadler-Nitu, Patti White	Smiley Room
	34. Transitioning Beyond Advanced ESL: Education and Work Skills -- Ss	Vincent Di Blasi	Templeton Suite
	35. Zero Preparation Activities for Reading and Writing -- Ss	Laurel Pollard	University Suite
	36. Fusion – A Unique Approach to Enhancing Teams	Debby Hewitt, Kimberly Vinton	Wiggins Room
11:40 – 12:40 p.m.	Lunch and Credential Celebration	Tomas Rivera Conference Ctr.	
12:50 – 2:50 p.m. (2 hours)	37. Working Together Works for Everyone! -- Ss	Stacey Milberger, Tiffany Johnson	Barry Room
	38. The ESL Student and the Workplace	Sandi Schneider	Elkins Room
	39. Engaging Parents – An Investment that Pays	Bev Schumacher	Ray Room
	40. Strategies for the GED Writing, Social Studies, and Science Tests	Dr. Steven Meeker	Smiley Room
	41. Developing Persistent and Successful Students -- Ss	Sarah Lynn	Templeton Suite
	42. A Look Inside the Mind: ESL/ABE Learners -- Ss	Amelia Gilley	University Suite
	43. Making Sense of Percents -- Ss	Richard Sedillo	Wiggins Room
2:50 – 3:05 p.m.	Break	Lobby Area	

-- Ss = Sessions appropriate for Students

CONFERENCE PRESENTATIONS

CONCURRENT SESSIONS FRIDAY, OCTOBER 22, 2010 12:50-2:50 P.M.

41. DEVELOPING PERSISTENT AND SUCCESSFUL STUDENTS TEMPLETON SUITE

Sarah Lynn, Pearson Longman ELT

The presenter will discuss common reasons students drop out of adult education programs and introduce research-supported strategies that can reverse that trend. The presenter will introduce classroom activities that focus on goal setting, monitoring learning, and developing independent study skills. Research indicates that these kinds of learning activities strengthen students' educational outcomes.

Target Audience: Instructors, Students, ESL, ABE/GED, Transitions

42. A LOOK INSIDE THE MIND: ESL/ABE LEARNERS UNIVERSITY SUITE

Amelia Gilley, Adult Education Consultant

This professional development module considers researched-based studies and educational behavioral theories describing how adults learn. Classroom strategies that engage the learner and help them to understand their own thinking processes are modeled for the participants.

Target Audience: Instructors, Students, ESL, ABE/GED

43. MAKING SENSE OF PERCENTS WIGGINS ROOM

Richard Sedillo, South Central Project GREAT

Do your students have difficulty understanding problems involving percents? This training will focus on how ABE/GED instructors can use a common sense, step-by-step approach to help their students gain an understanding of how to solve problems involving percents using percent bars.

Target Audience: Instructors, Students, ABE/GED

CONCURRENT SESSIONS FRIDAY, OCTOBER 22, 2010 3:10-4:10 P.M.

44. READING: A GLIMPSE INTO THE INVISIBLE BARRY ROOM

Dr. Ana Macias, University of Texas at El Paso

Presenter will present some insights on the nature of reading. What types of activities are going on in our minds which we don't hear about in the conversation on reading and what are the implications for teaching? Attendees will learn some conceptual notions about reading through a series of interactive exercises.

Target Audience: General Audience, ESL, Workforce Literacy, Family Literacy

45. CREDENTIAL: REFLECTION WRITING PANEL DISCUSSION ELKINS ROOM

Mary Lorenz and Denise Johnson, The Education Institute

Credentialed teachers that will participate in the panel: Miguel Martinez, Cecilia Hines, Veronica Mendoza, Michael Saenz and Rosanne Loya.

Have you started/completed your Teacher Credential yet? What's holding you back? A team of credentialed teachers and staff from the Adult Education Teacher Credential will share helpful hints and insights on how to maximize your staff development activities and action research projects and write effective reflections that will help you complete all Credential requirement quickly. Peer review and support will also be discussed as they are important ingredients for successful results. The purpose of this session is to assist and encourage teachers to dedicate uninterrupted time in their efforts to complete the requirements for the Texas Adult Education Teacher Credential.

Target Audience: Administrators, ABE/GED

46. LEARNING TO ACHIEVE SMILEY ROOM

Amelia Gilley, Educational Consultant

An initiative of National Institute for Literacy, Learning to Achieve is a training program designed to help adult education and vocational training practitioners, social workers, and other human service providers improve their knowledge of learning disabilities (LD) in adults.

Target Audience: General Audience, Students

CONFERENCE PRESENTATIONS

CONCURRENT SESSIONS FRIDAY, OCTOBER 22, 2010 9:30-11:30 A.M.

35. ZERO PREPARATION ACTIVITIES FOR READING AND WRITING UNIVERSITY SUITE

Laurel Pollard, Educational Consultant

Laurel Pollard will demonstrate interactive activities that require no teacher prep time, help students improve their skills in reading and writing, and can be used to teach any content at any level. With these activities, you can help your students learn more and avoid burnout at the same time!

Target Audience: General Audience, Students

36. FUSION-A UNIQUE APPROACH TO ENHANCING TEAMS WIGGINS ROOM

Debby Hewitt and Kimberly Vinton, South Central Project GREAT

This workshop will provide activities that leaders and educators can use to enhance trust, communication, problem solving, and team dynamics. The session will be fast paced, physical, interactive and exciting.

Target Audience: Administrators, Program Coord., Instructors, ESL, ABE/GED, Workforce Lit., EL Civics, Fam. Lit.

CONCURRENT SESSIONS FRIDAY, OCTOBER 22, 2010 12:50-2:50 P.M.

37. WORKING TOGETHER WORKS FOR EVERYONE! BARRY ROOM

Stacey Milberger and Tiffany Johnson, Victoria Adult Literacy Council

Distance learning and great partnerships with libraries, literacy programs and adult education providers build a more successful program. Come see how seven small towns offer online programs, tutoring, practice testing, technology training, and GED classes for students in a comfortable and easily accessible location. Pooling resources make many things possible!

Target Audience: General Audience, Students, ESL, ABE/GED, Workforce Lit., EL Civics, Transitions

38. THE ESL STUDENT AND THE WORKPLACE ELKINS ROOM

Sandi Schneider, South Central Project GREAT

This session will provide participants with current research findings about immigrants and the world of work as well as a forum to discuss this data. Participants will be actively engaged in acquiring a broader understanding of the relationship between the ESL student and the workplace in the United States.

Target Audience: Instructors, ESL, EL Civics

39. ENGAGING PARENTS—AN INVESTMENT THAT PAYS RAY ROOM

Bev Schumacher, Learning Props, Inc.

We know we should be working with parents as partners, but on the way to doing that the good intentions often get redirected. This session will focus on engagement strategies that will support parents in building their child's learning at home. When parents are engaged their children will do better in school.

Target Audience: General Audience

40. STRATEGIES FOR THE GED WRITING, SOCIAL STUDIES AND SCIENCE TESTS SMILEY ROOM

Dr. Steven Meeker, Montgomery I.S.D.

Strategies will be presented for helping students successfully pass the GED Writing, Social Studies, and Science exams. Specific emphasis will be given to the essay section of the writing exam. Participants will receive handouts with helpful examples. New teachers or teachers who are new to the GED will benefit from this session.

Target Audience: Instructors, ABE/GED

CONFERENCE SESSIONS AT A GLANCE

Friday, October 22, 2010 (Continued)

FRIDAY, OCTOBER 22, 2010			
TIME	ACTIVITY	PRESENTER	LOCATION
3:10 – 4:10 p.m. (1 hour)	44. Reading: A Glimpse into the Invisible	Dr. Ana Macias	Barry Room
	45. Credential: Reflection Writing Panel Discussion	Mary Lorenz, Denise Johnson	Elkins Room
	46. Learning to Achieve -- Ss	Amelia Gilley	Smiley Room
	47. Ratio, Proportions and Percent	Manuel Navarro	Templeton Suite
	48. Hands On Learning – MATH -- Ss	Irene Ramos	University Suite
	49. Sharing Some Stuff from My Big Bag of Tricks	Rita McSorley	Wiggins Room
	50. Prepare for the Job you Want! -- Ss	Judy Harris	Ray Room
4:10 p.m. – END OF CONFERENCE			

-- Ss = Sessions appropriate for Students

CONFERENCE PRESENTATIONS

WELCOMING AND KEYNOTE SPEAKER **8:15-9:30 A.M.**

Transitions: Steps to the Future—Career and College Pathways

**TOMAS RIVERA
CONFERENCE CENTER**

Dr. Lennox McLendon

Target Audience: All Adult Educators

CONCURRENT SESSIONS **THURSDAY, OCTOBER 21, 2010** **9:50-10:50 A.M.****1. THE PYTHAGOREAN THEOREM FOR ALL STUDENTS**

RAY ROOM

Richard Sedillo, South Central Project GREAT

Understanding how to use the Pythagorean Theorem is an important skill for all math students. This training will use a unique but common sense approach to show you how to guide all of your students when working with right triangles and the Pythagorean Theorem.

Target Audience: Instructors, Students, ABE/GED

CONCURRENT SESSIONS **THURSDAY, OCTOBER 21, 2010** **9:50-11:50 A.M.****2. PEER MENTORS: FORMER ADULT EDUCATION STUDENTS PLANTING POST-SECONDARY SEEDS**

BARRY ROOM

Angelica Garay, Joana Valles, Eva Hinojosa, El Paso Community College - LEAP Program

How do you plant postsecondary seeds in ESL/ABE/GED programs? This interactive session provides an opportunity for participants to experience the Peer Mentor Workshop as a "student". Former AE students will facilitate the workshop, share insight about addressing the postsecondary concerns of adult learners, and provide time for questions.

Target Audience: Administrators, Transitions

3. HOW DO YOU MANAGE YOUR CLASSROOM? A POSTER SESSION!

ELKINS ROOM

Carol Speigl, Project Learn to Read of San Antonio

How do you build "class as community"? How do you manage students "talking out of turn"? Together we will explore a variety of adult education classroom management questions, topics and strategies. Participants will create posters demonstrating classroom management techniques and strategies to be featured on the Far West GREAT website.

Target Audience: Administrators, General Audience, Students, ABE/GED, ESL, Workforce Literacy, Family Lit.

4. THE ESL CLASSROOM: PREPPING FOR THE WORKPLACE

SMILEY ROOM

Ellen Doyal, South Central Project GREAT

Story telling and images have been used as teaching tools ever since man first gathered around fires in caves. Consequently, our brains are hard-wired to remember images and stories. Participants will complete individual and group activities based on the use of picture stories. The activities, which are designed for ESL classrooms, develop English language learning and soft skills for the workplace.

Target Audience: Instructors, ESL, Workforce Literacy, EL Civics

5. MATH TOOLS FOR KINDERGARTEN, GED AND BEYOND

TEMPLETON SUITE

Anthony Chan, Texas LEARNS

The purpose of this workshop is to provide Math teachers with teaching strategies and simple tools that will help remove the fear of math that adult learners bring to class. Teachers will learn how to take math to a level more readily understood by their students.

Target Audience: Instructors, Numeracy, Transitions

Far West Project GREAT Center

14

CONFERENCE PRESENTATIONS

CONCURRENT SESSIONS **FRIDAY, OCTOBER 22, 2010** **8:10-9:10 A.M.****29. LEXILES FOR TRANSITIONS-USING TECHNOLOGY TO GUIDE INSTRUCTION**

WIGGINS ROOM

John Stevenson, Texas LEARNS

Participants will learn how to support instruction with the Lexile Framework for Reading, a technological tool that matches reading skills with reading levels of books. Teachers will learn how to use lexiles to align instruction to specific careers or college courses.

Target Audience: General Audience, ABE/GED, ESL, Assessment, Transitions

CONCURRENT SESSIONS **FRIDAY, OCTOBER 22, 2010** **9:30-11:30 A.M.****30. LOW LEVEL LEARNERS: TEACHING TIPS**

BARRY ROOM

Bronwyn Bowen, Abilene Adult Education

"Low-Level Learners: Teaching Tips" is a powerpoint review of teaching strategies that all ESL teachers should know, but sometimes forget. For new ESL teachers faced with very low-level beginners, it is an excellent checklist to help them achieve the best outcome, using such standard techniques as repetition pair work and pace of instruction.

Target Audience: Instructors, ESL

31. YOUNG CHILDREN AND FAMILIES: TRANSITIONS THROUGH STORY AND LITERACY

ELKINS ROOM

Dr. Elizabeth Quintero, California State University Channel Islands

In an interactive format, participants explore ways to use family stories, knowledge through community history, and multiple art forms to support children's transition to school. In spite of accountability and inappropriate assessment, children - with the support of family and community - can use their background knowledge to be successful in school.

Target Audience: General Audience, Students

32. PUTTING THE PAGES TOGETHER: A TOTAL APPROACH TO READING

RAY ROOM

Stacey Milberger and Tiffany Johnson, Victoria Adult Literacy Council

This hands-on presentation will bring all your teaching strategies together to create a reading program what will engage and reach even your most struggling readers! A reading program that incorporates the most effective teaching strategies, appropriate distance learning programs, and essential learning needs techniques will allow students to take responsibility for their learning and be successful. Our presentation will identify the most common struggles in reading studies and how instructors can help students to overcome those. Please join us for an entertaining session that will get you ready to read!

Target Audience: General Audience, ESL, ABE/GED

33. PROFESSIONAL PORTFOLIOS FOR POSTSECONDARY TRANSITIONS

SMILEY ROOM

Melissa Sadler-Nitu and Patti White, Seguin ISD, Adult Education and Phoenix Prog., St. Philip's College

This is a 2-hour workshop that demonstrates how to use Professional Portfolios in the ABE/ESL classroom to promote retention and transitions to higher education and/or the workforce.

Target Audience: General Audience

34. TRANSITIONING BEYOND ADVANCED ESL: EDUCATION AND WORK SKILLS

TEMPLETON SUITE

Vincent Di Blasi, Cambridge University Press

How can we provide our Adult ESL students with the skills they need to be successful in future education and work upon exiting ESL? In this session, we will look at how to incorporate note-taking, organization, writing, critical listening, reading and thinking skills from beginning to advanced levels.

Target Audience: General Audience, Students, ESL, ABE/GED, Transitions

Far West Project GREAT Center

19

CONFERENCE PRESENTATIONS

CONCURRENT SESSIONS	FRIDAY, OCTOBER 22, 2010	8:10-9:10 A.M.
23. READING AND LANGUAGE DEVELOPMENT OF DEAF ADULTS		BARRY ROOM
<i>Dr. Jean Andrews, Lamar University</i>		
Deaf teens and adults are vulnerable when caught in the criminal justice system because of their lack of English language and sign language abilities. Awareness of linguistic competency issues by educators and officials in the criminal justice system is needed to meet Deaf adults' literacy needs.		
Target Audience: General Audience, Special Learning Needs		
24. TEACHING IN THE MULTILEVEL CLASSROOM		ELKINS ROOM
<i>Sarah Lynn, Pearson Longman ELT</i>		
In this workshop the presenter will discuss ways in which student skills vary and then present simple and efficient ways to maximize students' learning. The techniques include strategically matching students by skill levels, assigning level appropriate tasks, and using a curriculum rich in visual and auditory material.		
Target Audience: Instructors, ESL		
25. DON'T CHOOSE MATERIALS FOR YOUR CLASS, CREATE THEM!		RAY ROOM
<i>Travis Hewgley, McGraw-Hill ESL</i>		
McGraw-Hill Create™—a new, self-service website that allows you to create custom course materials the way that makes the most sense for your course.		
Target Audience: Administrators, Instructors, ESL		
26. CONVERSATION CIRCLES AND OTHER CREATIONS THAT "DYNAMIZE" YOUR CLASS		SMILEY ROOM
<i>J. Arturo Muro R., Arthur Moore & More</i>		
Folks interested in developing their students' or staff's English-speaking confidence, and self-impression management skills must be made aware of how to conduct this creative, fulfilling activity. Mr. Muro has done it to great success and will disclose its inner working so that you, too, can use it.		
Target Audience: Administrators, Program Coordinators, ESL, Transitions		
27. THE MOST OFTEN MISSED QUESTION ON THE GED TESTS OF LANGUAGE ARTS, WRITING AND MATHEMATICS		TEMPLETON SUITE
<i>Bill Walker, Wonderlic, Inc.</i>		
Conferees will examine the outcomes of a study of over 100,000 GED test takers to identify the most often missed questions on the GED tests of Language Art, Writing and Mathematics. GED prep teachers will leave with proven strategies to teach their GED students.		
Target Audience: Administrators, Instructors, ABE/GED		
28. GEOMETRY IS JUST PLANE FUN!		UNIVERSITY SUITE
<i>Bonnie Goonen and Susan Pittman-Shetler, E-Learning Connections</i>		
Students often have problems interpreting real world situations and applying math skills to those situations. Geometry is just one area that students can use a "hands-on" approach to learn how to problem solve using math. This workshop will provide information on how to use common items to solve the basics of geometry, as well as the necessary skills of visualization.		
Target Audience: Instructors, ABE/GED, Numeracy		

CONFERENCE PRESENTATIONS

CONCURRENT SESSIONS	THURSDAY, OCTOBER 21, 2010	9:50-11:50 A.M.
6. STRESS-REDUCTION TECHNIQUES FOR TEACHERS AND STUDENTS		UNIVERSITY SUITE
<i>Laurel Pollard, Educational Consultant</i>		
Are your students sometimes stressed? Are you? Come and learn a wealth of stress-reducing principles and techniques including tips for simplifying paperwork, classroom management, and assessment, along with relaxation exercises you can share with your students. Comprehensive handout provided.		
Target Audience: General Audience, Students		
7. THE ORACY WORKSHOP		WIGGINS ROOM
<i>Dr. Thomas G. Sticht, Educational Consultant</i>		
Many adults who are native English language speakers are lacking in the oracy and literacy skills for school learning, technical training, college, and successful career progression. Much attention has been given to literacy in these life roles while little has focused on the oracy (listening, speaking) skills. This workshop provides an overview of research and practice that has been demonstrated to increase the ability of children and adults to communicate and learn more effectively by oracy, to improve their literacy via oracy, and to learn and perform in education, job training, and on the job more effectively using improved oracy skills. While focused on the native English speaker, the information may also be of interest to those teaching English for speakers of other languages (ESOL).		
Target Audience: Administrators, Instructors		
CONCURRENT SESSIONS	THURSDAY, OCTOBER 21, 2010	11:00-12:00 P.M.
8. FREE DISTANCE LEARNING CURRICULA FOR ESL		RAY ROOM
<i>Denise Guckert, Central Project GREAT</i>		
Of the several state-approved distance learning curricula for adult ESL students, three are actually free! These include USA LEARNS (Course 1), English for ALL, and the California Distance Learning Project. In this session, participants will view features of all three curricula, including student content and teacher interfaces for tracking progress.		
Target Audience: General Audience, Students, ESL		
CONCURRENT SESSIONS	THURSDAY, OCTOBER 21, 2010	1:10-3:10 P.M.
9. DIVING INTO DISTANCE LEARNING		BARRY ROOM
<i>Tiffany Johnson and Stacey Weaver, Victoria College, Adult Education</i>		
Many programs are apprehensive about the implementation of a distance learning component. It can seem overwhelming and often confusing. This interactive workshop can help you understand the basics of distance learning, dispel common misconceptions, and help you see how DL can work for your adult education program. We will offer a simple approach to ease you into DL using free curriculum or guide you all the way to an entire virtual DL world. This workshop is intended as a precursor to DL 101 or can be used to expand your current DL program.		
Target Audience: General Audience		
10. WHAT ABOUT FACTORING AND QUADRATIC EQUATIONS?		ELKINS ROOM
<i>Richard Sedillo, South Central Project GREAT</i>		
Learning how to factor and solving quadratic equations is a step towards college algebra and academic life after the GED. Twenty five percent (25%) of the GED math exam consists of topics involving algebra. A few items may involve factoring and solving quadratic equations. This training will use a common sense, step-by-step approach to show you how to guide your students when working with quadratic equations.		
Target Audience: Instructors, Students, ABE/ASE, Workforce Literacy		

CONFERENCE PRESENTATIONS

CONCURRENT SESSIONS	THURSDAY, OCTOBER 21, 2010	1:10-3:10 P.M.
11. BUILDING FAMILY AND EARLY LITERACY SKILLS BY CREATING BOOKS		RAY ROOM

Bev Schumacher, Learning Props, Inc.

Come to this "hands-on" session to explore construction methods and book styles. Motivate learning by making parents and children authors. Many practical learning experiences will be shared that use common resources found in the home and in the learning environment.

Target Audience: General Audience, Students, ESL, Fam. Lit., Transitions, Spec. Learning Needs

12. FEED THE STUDENT, FEED THE RACING MIND		SMILEY ROOM
--	--	-------------

Amelia Gilley, Adult Education Consultant

The notion that families on a budget cannot provide proper nutrition for optimum brain function is a myth. This training module educates the participants on how to manage attention deficit issues through nutrition at home, in the workplace, and in the classroom. This module is "classroom" ready and comes with content standard correlations.

Target Audience: General Audience, Students

13. ARE YOUR STUDENTS READY TO WRITE? TRANSITIONING BEYOND THE FIVE-PARAGRAPH ESSAY		TEMPLETON SUITE
---	--	-----------------

Bonnie Goonen and Susan Pittman-Shetter, E-Learning Connections, Inc.

From formal essays to research reports to note-taking, postsecondary education requires many different types of writing skills. Some students make very smooth transitions, but many are puzzled and frustrated by their experiences in writing for college classes. Learn more about the diverse writing skills required of our students as they transition to postsecondary education.

Target Audience: Instructors, ABE/GED, Transitions

14. ZERO PREPARATION ACTIVITIES FOR SPEAKING AND LISTENING		UNIVERSITY SUITE
--	--	------------------

Laurel Pollard, Educational Consultant

Laurel Pollard will demonstrate interactive activities that require no teacher prep time, help students improve their skills in speaking and listening, and can be used to teach any content at any level. A repertoire of such activities gives teachers time to relax, reflect, and recover their vision.

Target Audience: Instructors, Students

15. DEVELOPING ORAL COMMUNICATION USING HANDS-ON ACTIVITIES		WIGGINS ROOM
---	--	--------------

Sandi Schneider, South Central Project GREAT

A major goal of ESL students at all levels is a desire to improve oral communication in English. Research says we all learn better when we are actively involved in the learning processes. This session suggests several hands-on activities that will help students to become more proficient in oral communication.

Target Audience: Instructors, ESL, EL Civics

CONCURRENT SESSIONS	THURSDAY, OCTOBER 21, 2010	3:30-4:30 P.M.
16. FINANCIAL LITERACY: A NEW APPROACH TO GED EDUCATION		BARRY ROOM

Brittany Kellerman, Kieran Healy, Leah Diaz, El Paso Affordable Housing

Developing life skills is crucial to an individual's success. By integrating financial education within a GED curriculum, students may achieve the capability to budget, manage their credit, develop assets, and become financially secure. This interactive workshop will encourage instruction to brainstorm potential teaching methods and to provide feedback on the materials.

Target Audience: General Audience

Far West Project GREAT Center

16

CONFERENCE PRESENTATIONS

CONCURRENT SESSIONS	THURSDAY, OCTOBER 21, 2010	3:30-4:30 P.M.
17. DICTIONARY DUST BLOWERS		ELKINS ROOM

Sarah Worthington, Educational Consultant

Dictionaries are great tools for building language and literacy skills, but they're often underutilized in the classroom. This workshop will provide you with a variety of dictionary-based activities that will have your students searching through and learning about dictionaries. Activities at all levels, from alphabetization to creating mock entries will be demonstrated.

Target Audience: Administrators, Instructors, ABE/GED

18. ALL-STAR, SECOND EDITION		RAY ROOM
------------------------------	--	----------

Travis Hewgley, McGraw-Hill ESL

All-Star, Second Edition is a four-level, standards-based series for adult English learners featuring a Big Picture-dictionary approach to vocabulary building. It features a new Target Grammar section, CASAS-style listening, student Work-Out CD-ROM, and Online Teacher Resources, giving students and teachers the tools for success.

Target Audience: Prog. Coord., Instructors, Students, ESL

19. MATH STRATEGIES FOR THE GED		SMILEY ROOM
---------------------------------	--	-------------

Dr. Steven Meeker, Montgomery I.S.D.

Strategies will be presented for helping students successfully pass the GED Math exam. Specific areas of focus will include percentages, algebra, and geometry. All participants will receive handouts with helpful examples. New teachers or teachers who are new to the GED Math examination will benefit from this workshop.

Target Audience: Instructors, ABE/GED

20. THE FIRST LADY'S FAMILY LITERACY INITIATIVE FOR TEXAS—A GREAT OPPORTUNITY FOR COMMUNITY-BASED LITERACY PROGRAMS!		TEMPLETON SUITE
--	--	-----------------

Harriet V. Smith and Emily Moore, TCALL

The First Lady's Family Literacy Initiative for Texas was launched by Laura Bush while she was First Lady of Texas. Each year, the Initiative awards \$50,000 grants for family literacy programs that focus on multi-generational reading instruction, and provide structured time for parents and children to read and learn together.

Target Audience: Administrators, Family Literacy

21. PREPARE FOR THE JOB YOU WANT!		UNIVERSITY SUITE
-----------------------------------	--	------------------

Judy Harris, Frankford Candy Co. and University of Phoenix

The unemployment rate has reached more than 10% in the US. Those who are unemployed use the Internet, networking, referrals, and direct applications as a resource to obtain employment. There is also a group of adults that are employed who are planning or would like to leave their present employer. However, many of these adults do not have current skills for job hunting, interviewing, or resume preparation. Adults may have to relearn resume preparation, applying online, and networking skills.

Target Audience: General Audience, Students, Workforce Literacy, Transitions

22. THE HILTON CHALLENGE-CHANGING LIVES THROUGH THE TISESL PROGRAM		WIGGINS ROOM
--	--	--------------

Karla Horelica, ESC-Region VI

"The Hilton Challenge" is the story of how the TISESL program transitioned non-English speaking Hilton Hotel employees from working and living in Mexico to working and living in Aggie Land. This presentation will focus on the development of industry specific vocabulary which helps make an employee successful in communicating with their Hilton guests.

Target Audience: General Audience, ESL, Workforce Literacy, Transitions

Far West Project GREAT Center

17